



Référence: E13*81R00/02*9885*02

Annexes: - Rapport Technique
- Fiche de Renseignements du constructeur

Bertrange, le 10 février 2025



Communication concernant: - ~~DELIVRANCE D'UNE HOMOLOGATION~~
Communication concerning: - ~~APPROVAL GRANTED~~
- ~~EXTENSION D'HOMOLOGATION~~
- ~~APPROVAL EXTENDED~~
- ~~REFUS D'HOMOLOGATION~~
- ~~APPROVAL REFUSED~~
- ~~RETRAIT D'HOMOLOGATION~~
- ~~APPROVAL WITHDRAWN~~
- ~~ARRET DEFINITIF DE LA PRODUCTION~~
- ~~PRODUCTION DEFINITELY DISCONTINUED~~

d'un type de rétroviseur, conformément au Règlement N° 81
of a type of rear-view mirror pursuant to Regulation N° 81

Numéro d'homologation:

Approval number:

E13*81R00/02*9885*02

Marque d'homologation:

Approval mark:

L  009885

1. Marque de fabrique ou de commerce du dispositif:

Trade name or mark of the equipment:

motogadget

2. Type:

Equipment type:

7006010

3. Description sommaire comportant notamment les indications suivantes:

Brief description including in particular the following information:

3.1. Dimensions principales de la surface réfléchissante:

Main dimensions of the reflecting surface:

max. length: 116,7 mm
max width: 80,5 mm

3.2. Rayon de courbure nominal de la surface réfléchissante:

Nominal radius of curvature of the reflecting surface:

1450 mm

4. Nom et adresse du fabricant:

Manufacturer's name and address:

motogadget GmbH
Wollenberger Str. 4 i-j
D-13053 Berlin

5. **Nom et adresse du représentant du fabricant (le cas échéant):**
If applicable, name and address of the manufacturer's representative: not applicable
6. **Présenté à l'homologation le:**
Equipment submitted for approval on: 20.12.2024
- Service technique chargé des essais d'homologation:**
Technical service responsible for conducting approval tests: Luxcontrol SA
8. **Date du procès-verbal délivré par ce service:**
Date of report issued by that service: 15.01.2025
9. **Numéro du procès-verbal délivré par ce service:**
Number of report issued by that service: LC 2109 001 24
10. **Véhicules pour lesquels le dispositif est destiné:**
Vehicles for which the equipment is designed: two-wheeled motor vehicles
11. **L'homologation est 2/:**
Approval is 2/: ~~accordée / refusée / étendue / retirée~~
~~granted / refused / extended / withdrawn~~
12. **Motif(s) de l'extension de l'homologation:**
Reason(s) for extension of approval: refer to Index of technical report
13. **Lieu:**
Place: Bertrange
14. **Date:**
Date: 10 février 2025
15. **Signature:**
Signature:

Pour la Ministre de la Mobilité
et des Travaux publics



Iliass ZERKTOUNI
Attaché

Pour la SNCH



Laurent LINDEN
Directeur opérationnel



16. Est annexée la liste des pièces constituant le dossier d'homologation déposé au Service administratif ayant délivré l'homologation:

A list of documents contained in the approval file transmitted to the administrative service which has granted approval is annexed to this communication:

see index to type-approval report



Référence: E13*81R00/02*9885*02

Annexes: - Rapport Technique
- Fiche de Renseignements du constructeur

Bertrange, le 10 février 2025

Index du dossier d'homologation

Index to type-approval report

Numéro d'homologation: Approval number:	E13*81R00/02*9885*02
Révision: Revision:	00
Marque de fabrication ou de commerce: Trade name or mark:	<u>motogadget</u>
Type: Type:	7006010
1. Procès-verbal d'essai: Test report:	N° LC 2109 001 24
- Technical report:	Page(s) 1 to 3;
- Index:	Page(s) 1 & 2;
- Communication as numbered in the standard:	Annex A - Page(s) 1;
- Test results:	Annex B - Page(s) 1 & 2.
2. Dossier du constructeur: Report of the manufacturer:	N° Annex C
- Information document:	Page(s) <u>1 to 12</u> .
3. Autres documents annexés: Other documents annexed:	not applicable
4. Date de délivrance de l'homologation initiale: Date of issue of initial type approval:	14.07.2021
5. Date de la dernière délivrance de pages révisées: Date of last issue of revised pages:	not applicable
6. Date de la dernière délivrance d'une homologation révisée: Date of last extension:	10.02.2025

TECHNICAL REPORT

No.: LC 2109 001 24

Inspection concerning

the approval of rear-view mirrors and of two-wheeled power-driven vehicles with or without side car, with regard to the installation of rear-view mirrors on handlebars

performed according to

**ECE-Regulation No. 81
series of amendments: 00
Including supplement: 2**

Type approval previously granted: **E13*81R00/02*9885*01**

E13*81R00/02*9885*02

Société Nationale de Certification et d'Homologation

Contents:

1. General
 2. Test details
 3. Statement of compliance
- Index

A reproduction of this report and its annexes, except in full, is prohibited without the written permission of Luxcontrol s.a.

Luxcontrol SA is accredited by OLAS under the accreditation number (3/016) against ISO/IEC 17020, for the technical domains listed in the technical scope available via the following link:

<https://portail-qualite.public.lu/fr/accreditation-notification/organismes-accredites/inspection/lc-mobility.html>

...



1. **General**

Manufacturer: **motogadget GmbH
Wollenberger Str. 4 i-j
D-13053 Berlin**

~~Vehicle Type~~
~~Or component or ESA or STU:~~ **7006010**

2. **Test details**

	Inspector	Location of test:	Date of receipt of test item:	Date of test:
Main report	A.Tomasini	Eurolens I – Paderno Dugnano (MI)	May 2021	20.05.2021
Extension 01	R. Limpach	Luxcontrol SA L-4004 Esch/Alzette	n.a.	25.09.2024
Extension 02	A.Tomasini	Eurolens I – Paderno Dugnano (MI)	December 2024	20.12.2024

2.1. **Remarks**

2.1.1. Main report:
not applicable

2.1.2. Extension 1:
Manufacturer address changed. No tests required / performed. Previous results stay valid.

2.1.3. Extension 2:
Trade name / mark revised. Max. length of reflecting surface revised in drawing. New internal manufacturer / customer information (number) issued. New tests performed and validated to cover the added versions stated in the index.



3. **Statement of compliance**

The inspections items and measurements carried out have shown the compliance of the type described in this technical report and the attached Annexes with the requirements of the standard as stated on page 1.

Belvaux, January 15, 2025

Luxcontrol s.a.
Service Homologation-automobile

Romain Limpach
Ingénieur-Inspecteur

Angelo Tomasini
Ingénieur-Inspecteur

Annexes



Details to the information package, including a summary in chronological order, concerning extensions and/or amendments

Type-approval previously granted: **E13*81R00/02*9885*01**

Main Report

Technical Report No.:	LC 1289 002 21	3 Pages
	Index	1 Page

List of Annexes:

A: Communication as numbered in the standard	1 Page
B: Test results	2 Pages
C: Information folder	3 Pages

Extension 1

Technical Report No.:	LC 1289 003 24	3 Pages
	Index	1 Page

List of Annexes:

A: Communication as numbered in the standard	1 Page
B: Test results	2 Pages
C: Information folder	3 Pages
To be replaced:	all (Pages 1 to 3)

Content of the extension:

To be revised:

- Manufacturer's address
- Editorial arrangements

Extension 2

Technical Report No.:	LC 2109 001 24	3 Pages
	Index	2 Pages

List of Annexes:

A: Communication as numbered in the standard	1 Page
B: Test results	2 Pages
C: Information folder	
To be deleted:	all (3 Pages)
To be added:	12 Pages



To be added:

- Versions 7006011; 7006083; 7006070; 7006073; 7006060; 7006063;
7006061; 7006062; 7006052; 7006050; 7006051

To be revised:

- Max. length of reflecting surface in drawing
- Trade name / mark
- New internal manufacturer / customer information (number)

Content of the information folder:

- manufacturer's information document (page 1 to 12)
-



COMMUNICATION AS NUMBERED [] IN THE STANDARD

- [1.] Trade name or mark:
motogadget
- [2.] Type:
7006010
- [3.] Brief description including in particular the following information:
- [3.1.] Main dimensions of the reflecting surface:
max. length: 116,7 mm
max. width: 80,5 mm
- [3.2.] Nominal radius of curvature:
1450 mm
- [4.] Name and address of the manufacturer:
motogadget GmbH
Wollenberger Str. 4 i-j
D-13053 Berlin
- [5.] Name and address of manufacturer's authorised representative:
not applicable
- [6.] Equipment submitted for type approval on:
20.12.2024
- [10.] Vehicles for which the equipment is designed:
Two - wheel motor vehicles
- [12] Reason(s) for extension of approval:
Versions 7002080; 7002083; 7002070; 7002073; 7002060; 7002063;
7002061; 7002062; 7002052; 7002050; 7002051 added.
Max. length of reflecting surface revised in drawing.
Trade name / mark revised.
New internal manufacturer / customer information (number)



1. Test results:

1.1. Version of the tested vehicle/item

Following version(s) has (have) been used for testing (if not stated in part 1.2.1. of this report):

Main report:

E13*81R00/02*9885*02

- 7006010

Société Nationale de Certification et d'Homologation

Extension 1: Verifications done based on documents

Extension 2:

- 7006050

The tested items are representative of the worst case.

1.2. Inspection items

1.2.1. General specifications:

The trade mark is engraved clearly legible and indelible on the back side of the device.

1.2.1.1. Adjustment of the rear-view mirror

The reflecting surface of the rear-view mirror is manually adjustable

1.2.1.2. Rear-view mirror holder (protective housing):

Not applicable, as the reflective surface is machined from a single part of aluminum.

1.2.1.2.1. Radius of curvature of contactable parts of the rear-view mirror:

All parts, irrespective of the adjustment position of the device, which can be in static contact with a sphere of 100 mm, have a radius of curvature of "**c**" > **2,5 mm**.

1.2.1.3. Dimensions of the reflecting surface:

The reflecting surface has an area of **more than 69 cm²**. It is possible to inscribe a circle of **min. 78 mm** on the reflecting surface.

1.2.1.4. Reflecting surface and coefficient of reflection:

Radius of curvature: **1450 mm**

Coefficient of reflection: **> 40 %**



1.2.1.5. The results indicated below have been achieved by adjusting the mirror to the installation angle of:

Test (*)	Impact test results [°]		Observations
	left	right	
1	> 20°	--	no cracks / no separations
	--	> 20°	no cracks / no separations

(*) according to paragraph 8.2 and 8.4. of the Regulation

1.2.1.6. Bending test:

Not applicable for external mirrors.

1.3. Remark

1.3.1. General:

The inspection results are applicable to all the variants/versions named in the manufacturer's information folder (annex C). The tested rear-view mirror variants/versions cover the worst cases for the different situations

1.4. Test facilities

Calibration of measuring and test equipment used to carry out the inspections is in accordance with the ECE-Regulation stated in 1.1. of this report and with ISO 17025

E13*81R00/02*9885*02

Société Nationale de Certification et d'Homologation

E13*81R00/02*9885*02
Société Nationale de Certification et d'Homologation



motogadget GmbH, Wollenberger Str. 4 i-j, 13053 Berlin

Ministry for Sustainable Development and Infrastructure
Transport Division
4, place de l'Europe
L-1499 Luxembourg

Berlin, 05.12.2024

Information document

Name and address of manufacturer : *motogadget GmbH
Wollenberger Str. 4 i-j
D-13053 Berlin*

Trade Name: motogadget

Type: 7006010

Version(s):

7006011

7006083

7006070

7006073

7006060

7006063

7006061

7006062

7006052

7006050

7006051

motogadget GmbH
Wollenberger Str. 4 i/j
13053 Berlin

www.motogadget.com
info@motogadget.de
Tel. +49-(0)30-69004100

Sitz der Gesellschaft ist Berlin
Registergericht AG Charlottenburg
HRB 117611 B

Geschäftsführer
Garrit Keller
Ust.Id.: DE263545235

Bankverbindung
motogadget GmbH
Postbank Berlin

IBAN DE16100100100006097102
BIC PBNKDEFF

Details regarding the attachment: *(Please refer to the technical drawing for description how mirror bracket is attached to the handlebar)*

General remarks: *The rear-view mirror does not have any glass components, but the reflecting surface is machined from a single piece of aluminium*

Best regards,

Garrit Keller
(Managing Partner)

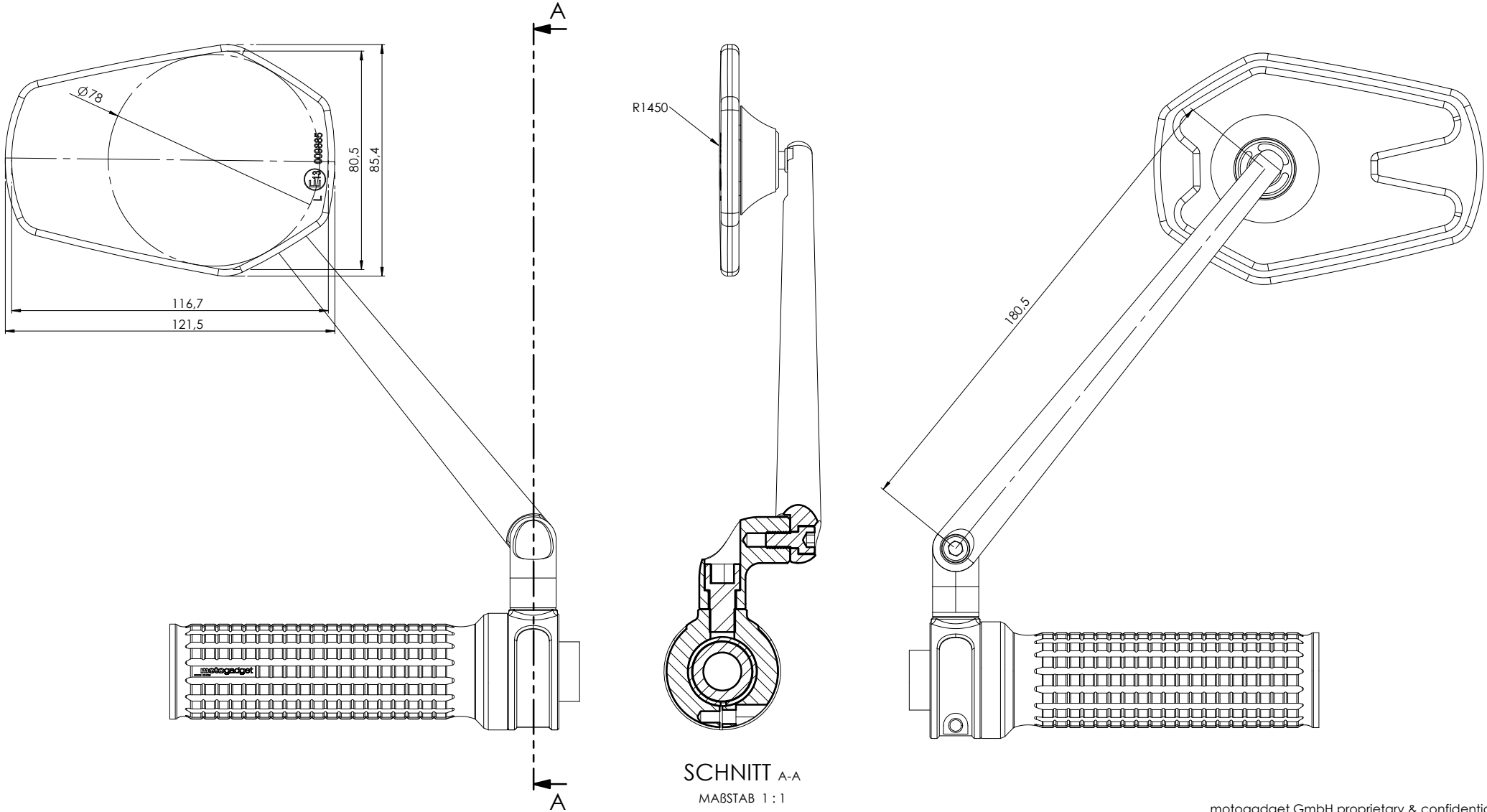

SCHNITT A-A
 MABSTAB 1:1

Spiegelkörper: DRIFT
 Arm: 180mm
 Gelenk: fix
 SKU: 7006011

motogadget GmbH proprietary & confidential

WENN NICHT ANDERS DEFINIERT: BEWASSUNGEN SIND IN MILLIMETER		OBERFLÄCHENGÜTE:		ENTCRATEN UND SCHARFE KANTEN RISCHEN		ZEICHNUNG NICHT SKALIEREN		ÄNDERUNG	
OBERFLÄCHENBESCHAFENHEIT: FOKUSANZEIGER: LINEAR: WINKEL:									
BEZEICHNET	NAME	SIGNATUR	DATUM			REFERENZ:			
GEPROBT						mo.view_drift			
GENEHMIGT									
PRODUKTION									
QUALITÄT									
				WERKSTOFF:		ZEICHNUNGSNR.		A2	
				GEWICHT:		MASSSTAB: 1:1		BLATT 1 VON 10	

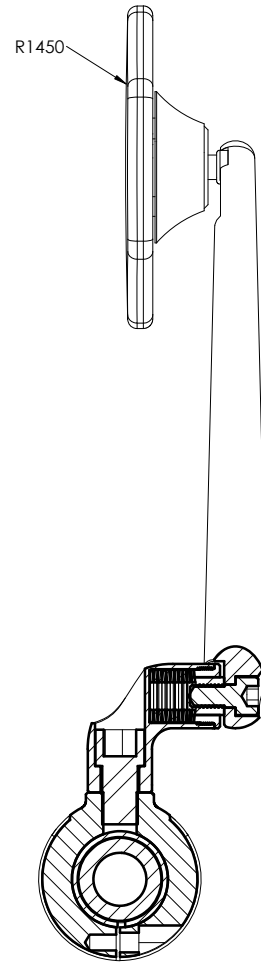
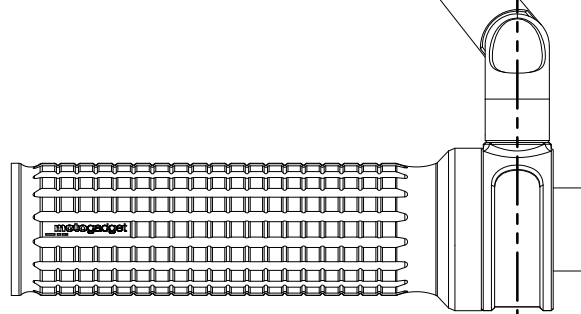
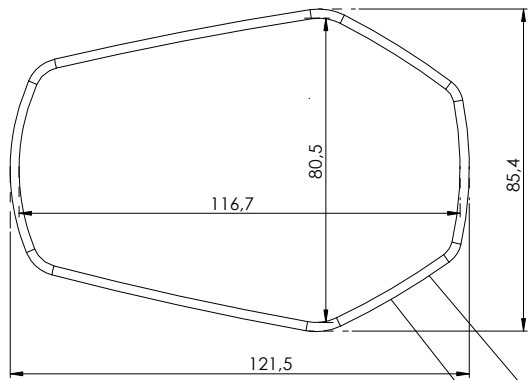

SCHNITT B-B
MAßSTAB 1 : 1

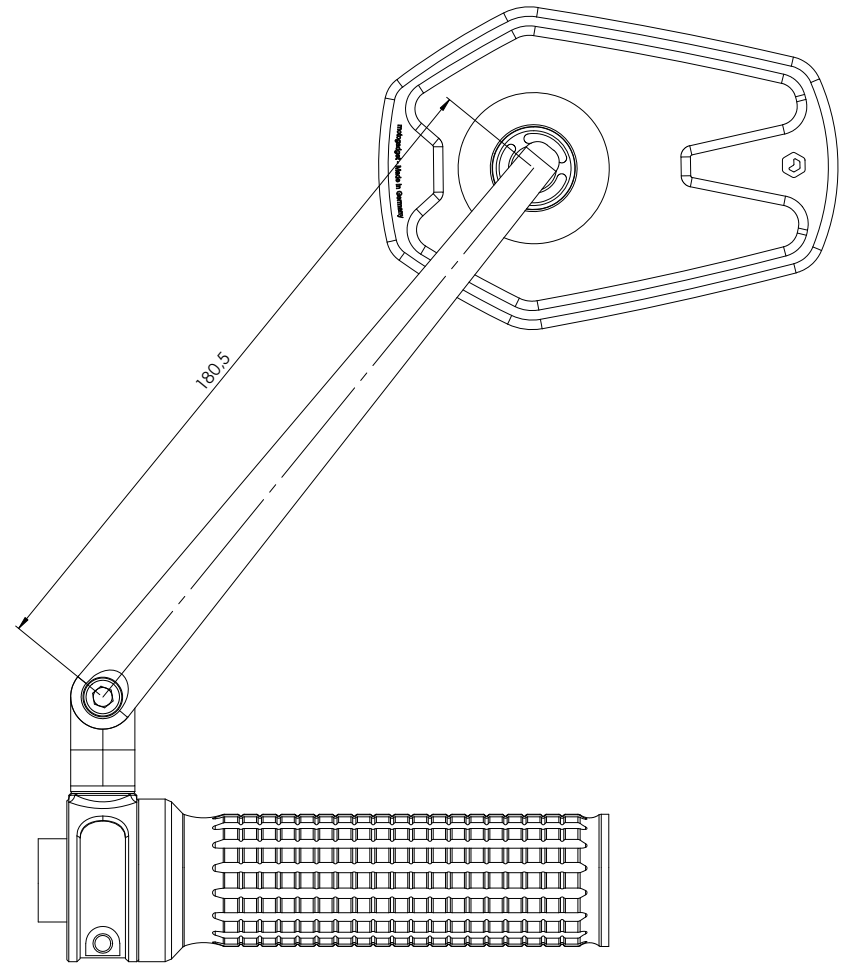

Spiegelkörper: DRIFT
Arm: 180mm
Gelenk: flip
SKU: 7006083

Spiegelarm ist schwenkbar in diskreten 45° Rastschritten

motogadget GmbH proprietary & confidential

WENN NICHT ANDERS DEFINIERT: BEWERTUNGEN SIND IN MILLIMETER		OBERFLÄCHENGÜTE:		ENTCRATEN UND SCHARFE KANTEN BRUCHEN		ZEICHNUNG NICHT SKALIEREN		ÄNDERUNG	
FOLIERENZEN: LINEAR: WINKEL:									
BEZEICHNUNG:	NAME:	SIGNATUR:	DATUM:			REFERENZ:			
SERIE:						mo.view_drift			
PRODUKTION:						WERKSTOFF:		RECHENUNGSNR.	
QUALITÄT:								A2	
						GEWICHT:		MAßSTAB: 1	
								BLATT 2 VON 10	

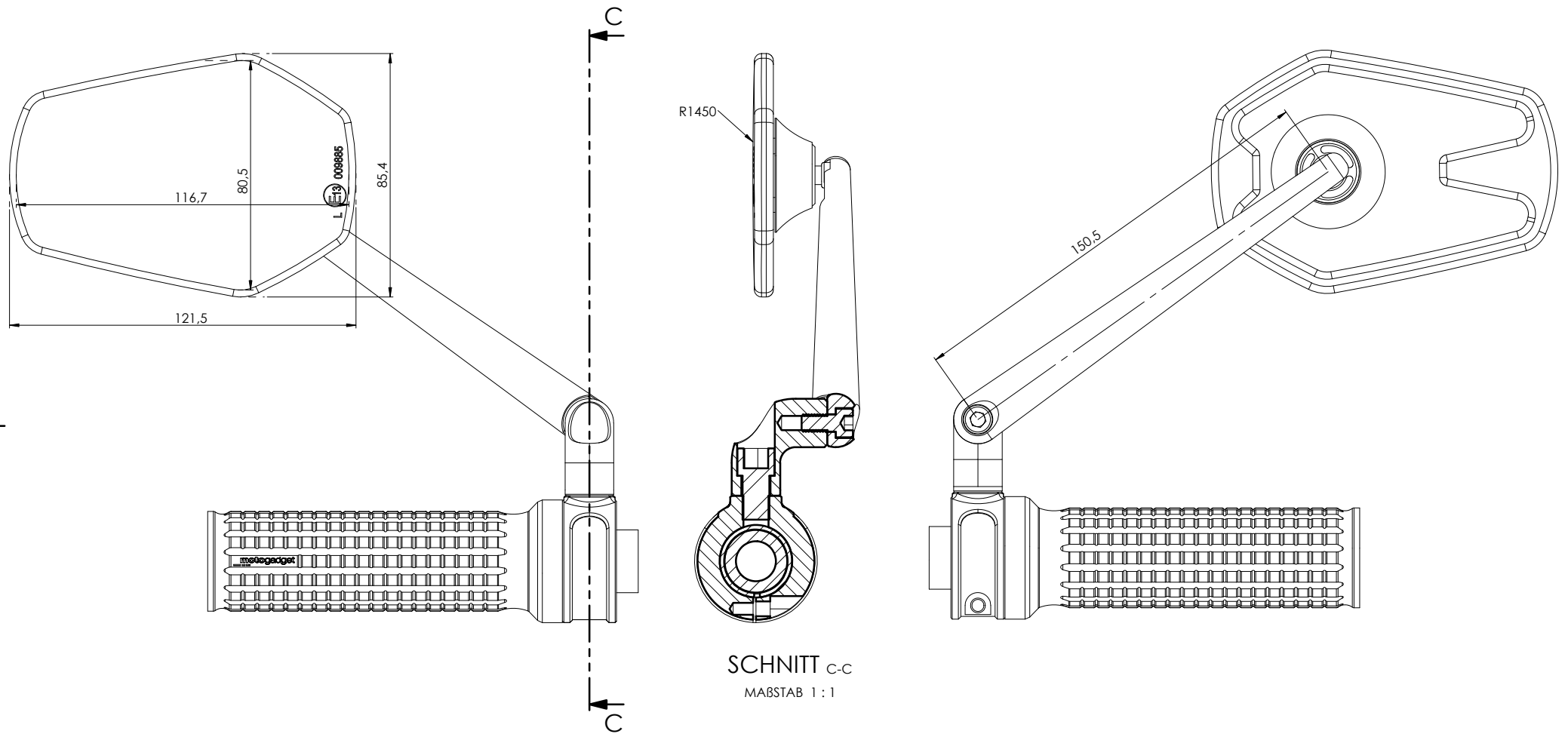

SCHNITT C-C
MAßSTAB 1 : 1

Spiegelkörper: DRIFT
Arm: 150mm
Gelenk: fix
SKU: 7006070

motogadget GmbH proprietary & confidential

WENN NICHT ANDERS DEFINIERT: BEWASSUNGEN SIND IN MILLIMETER		OBERFLÄCHENGÜTE:		ENTCRATEN UND SCHARFE KANTEN RISCHEN		ZEICHNUNG NICHT SKALIEREN		ÄNDERUNG	
LINEAR: WINKEL:		TOLERANZEN:							
BEZEICHNET:	NAME	SIGNATUR	DATUM			REFERENZ:			
ZEICHNET:						mo.view_drift			
PRODUKTION:						WERKSTOFF:		RECHNUNGSNR.	
QUALITÄT:								A2	
				GEWICHT:		MAßSTAB: 1:2		BLATT 3 VON 10	

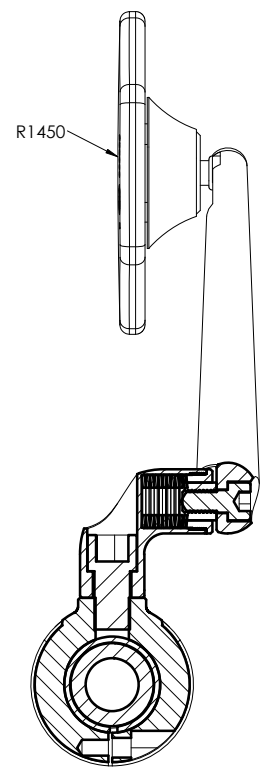
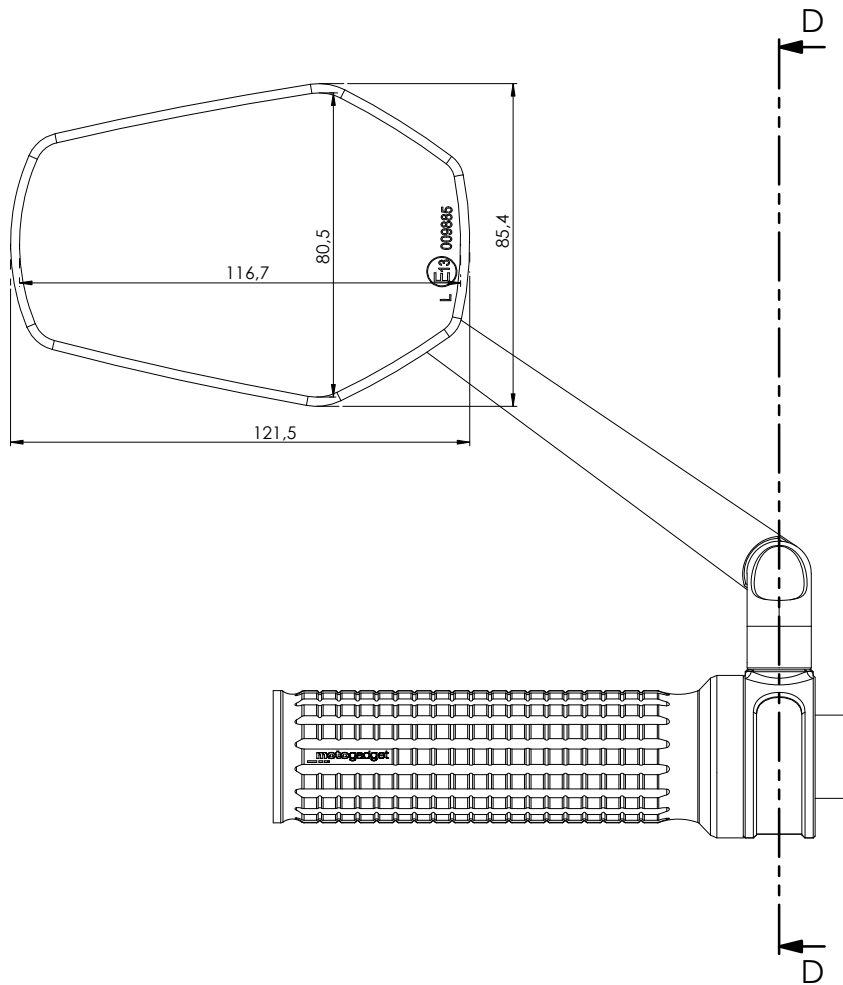

SCHNITT D-D
MABSTAB 1 : 1

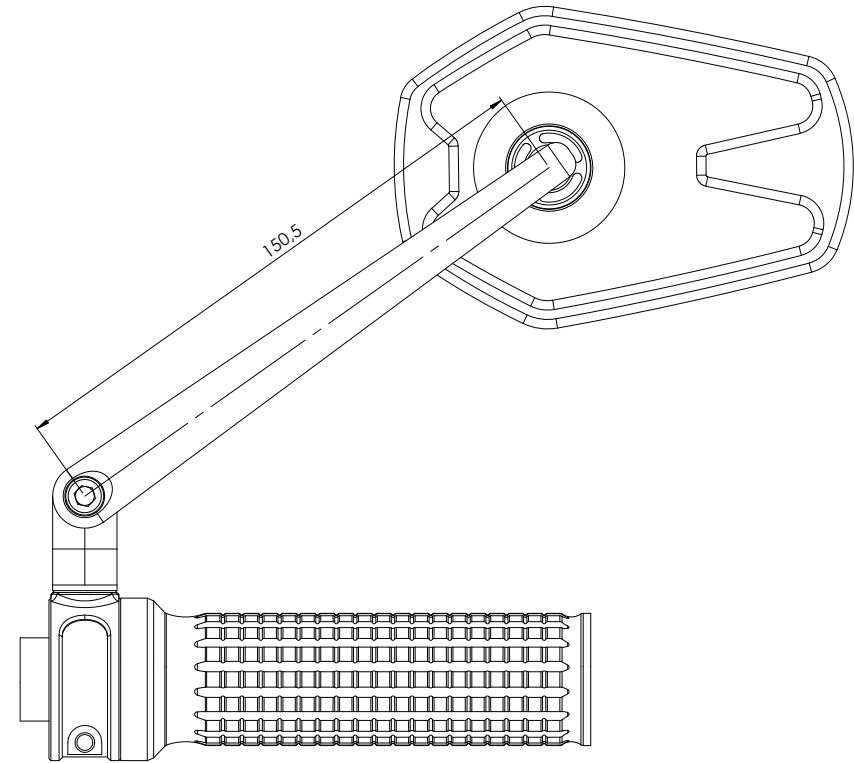

Spiegelkörper: DRIFT
Arm: 150mm
Gelenk: flip
SKU: 7006073

Spiegelarm ist schwenkbar in diskreten 45° Rastschritten

motogadget GmbH proprietary & confidential

WENN NICHT ANDERS DEFINIERT: BEWASSUNGEN SIND IN MILLIMETER		OBERFLÄCHENGÜTE:		ENTCRATEN UND SCHARFE KANTEN RISCHEN		ZEICHNUNG NICHT SKALIEREN		ÄNDERUNG	
OBERFLÄCHENBESCHAFFENHEIT: FOKUSSTÄNDE: LINEAR: WINKEL:									
BEZEICHNUNG	NAME	SIGNATUR	DATUM			REFERENZ:			
ZEICHNER						mo.view_drift			
BEFÄHIGT									
PRODUKTION									
QUALITÄT				WERKSTOFF:		ZEICHNUNGSNR.			
				GEWICHT:		MASSSTAB: 1			
						BLATT 4 VON 10			
						A2			

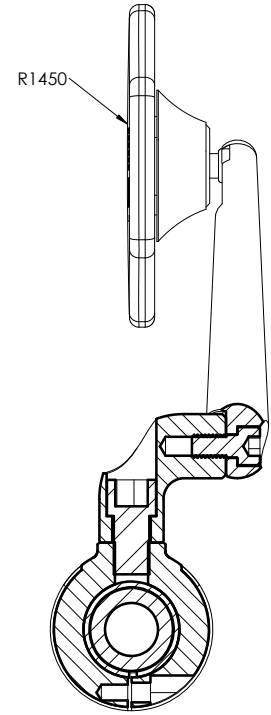
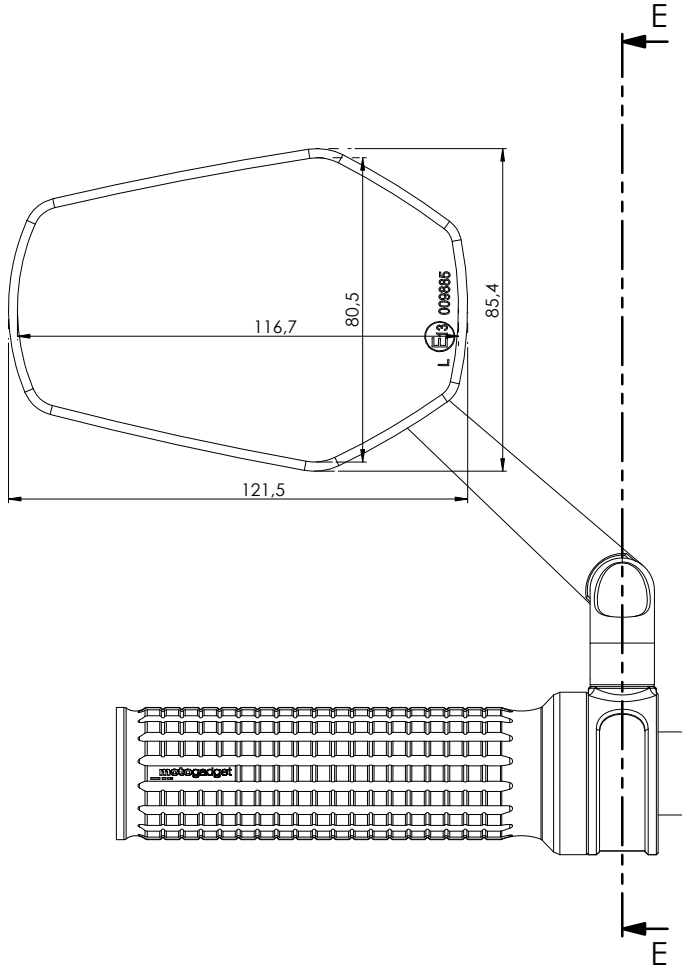

SCHNITT E-E
MAßSTAB 1 : 1

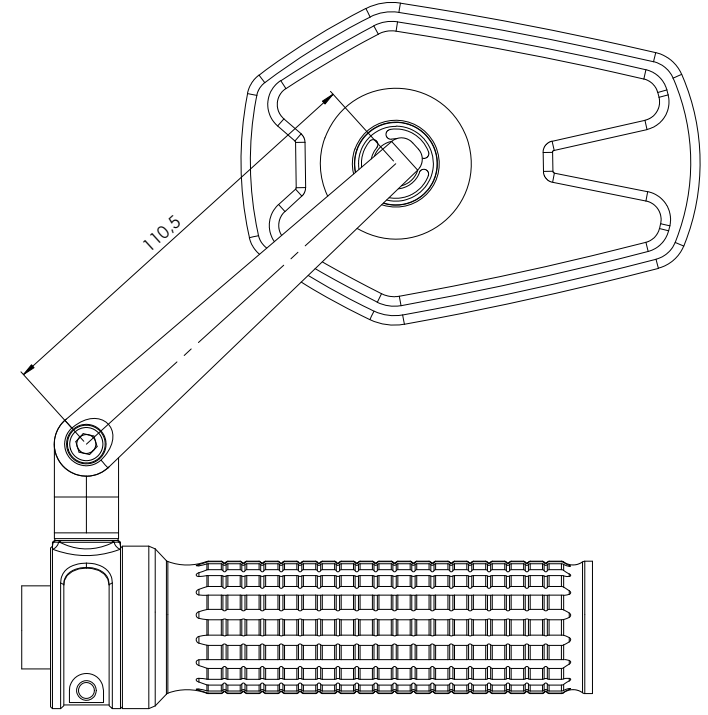

Spiegelkörper: DRIFT
Arm: 110mm
Gelenk: fix
SKU: 7006060

motogadget GmbH proprietary & confidential

WENN NICHT ANDERS DEFINIERT: BEWASSUNGEN SIND IN MILLIMETER OBERFLÄCHENBESCHAFENHEIT: FOKUSLÄNGE: LINEAR: WINKEL:		OBERFLÄCHENGÜTE:	ENTCRATEN UND SCHARFE KANTEN RISCHEN	ZEICHNUNG NICHT SKALIEREN	ÄNDERUNG
BEZEICHNUNG	NAMM	SIGNATUR	DATUM	REFERENZ:	
ZEICHNER				mo.view_drift	
PROJEKTLEITER				RECHENUNGSNR.	A2
PRODUKTION			WERKSTOFF:	MAßSTAB: 1	BLATT 3 VON 10
QUALITÄT			GEWICHT:		

E13*81R00/02*9885*02
 Société Nationale de Certification et d'Homologation

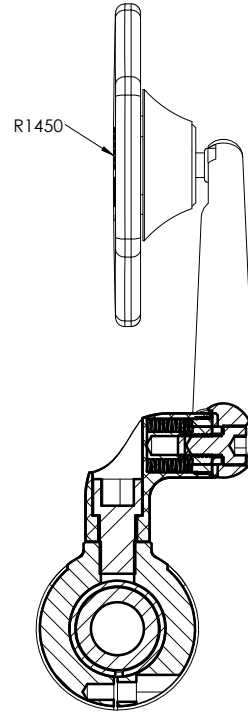
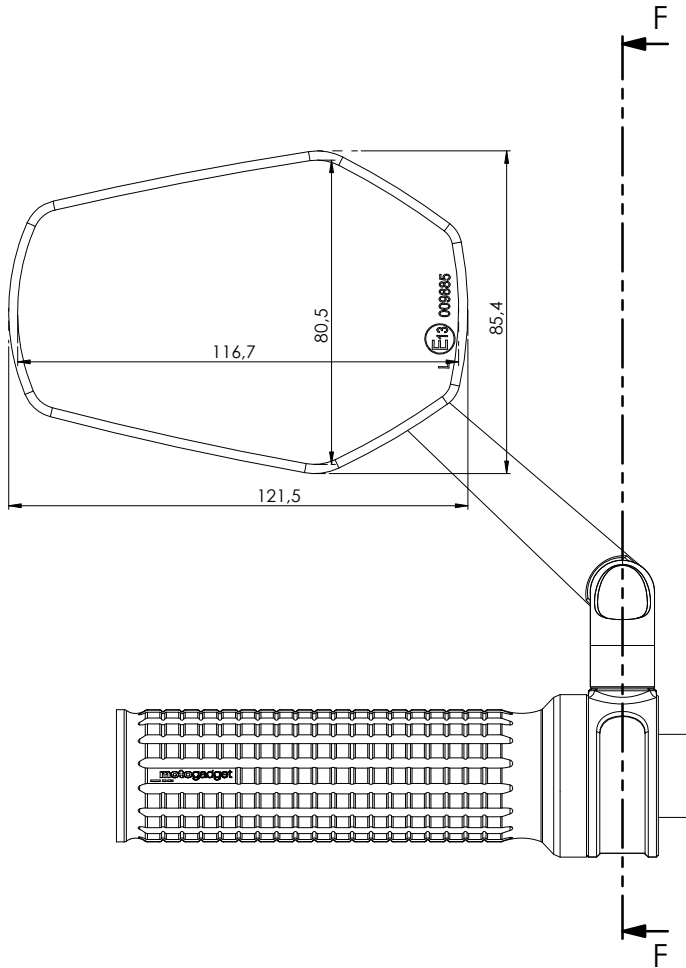

SCHNITT F-F
 MABSTAB 1 : 1

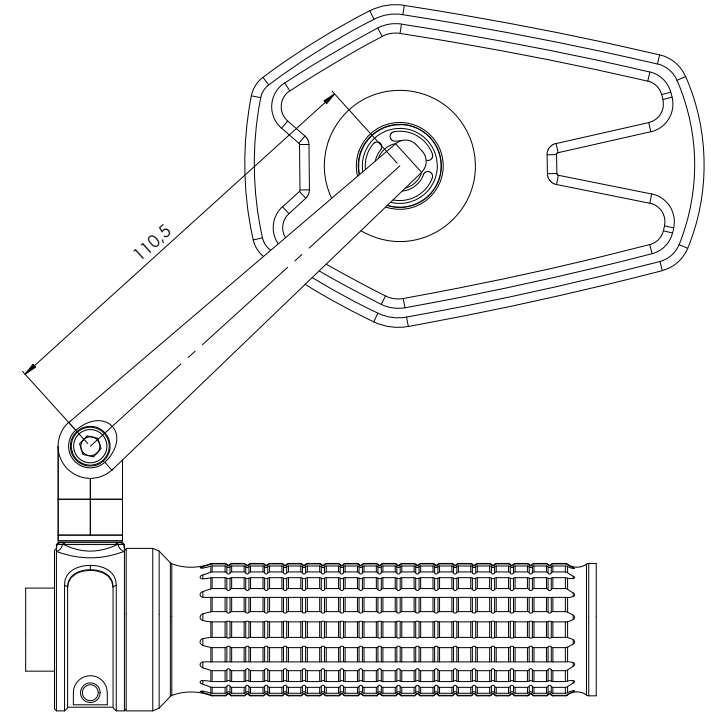

Spiegelkörper: DRIFT
 Arm: 110mm
 Gelenk: flip
 SKU: 7006063

Spiegelarm ist schwenkbar in diskreten 45° Rastschritten

motogadget GmbH proprietary & confidential

WENN NICHT ANDERS DEFINIERT: BEWASSUNGEN SIND IN MILLIMETER		OBERFLÄCHENGÜTE:		ENTGRATEN UND SCHARFE KANTEN RUNDEN		ZEICHNUNG NICHT SKALIEREN		ÄNDERUNG	
OBERFLÄCHENBESCHAFFENHEIT: FOKUSLÄNZE: LINEAR: WINKEL:									
BEZEICHNET	NAME	SIGNATUR	DATUM			BEZIEHUNG:			
GEZEICHNET						mo.view_drift			
GEZEICHNET									
PRODUKTION:				WERKSTOFF:		ZEICHNUNGSNR.			
QUALITÄT:						A2			
				GEWICHT:		MASSSTAB: 1			
						BLATT & VON ID			

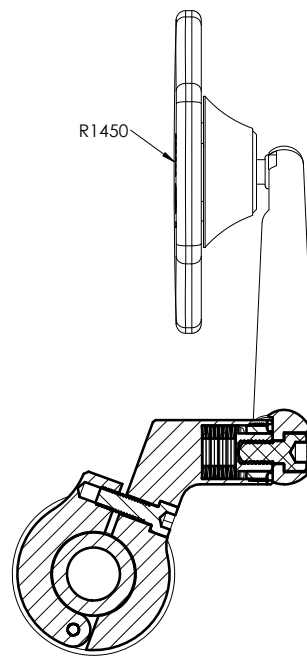
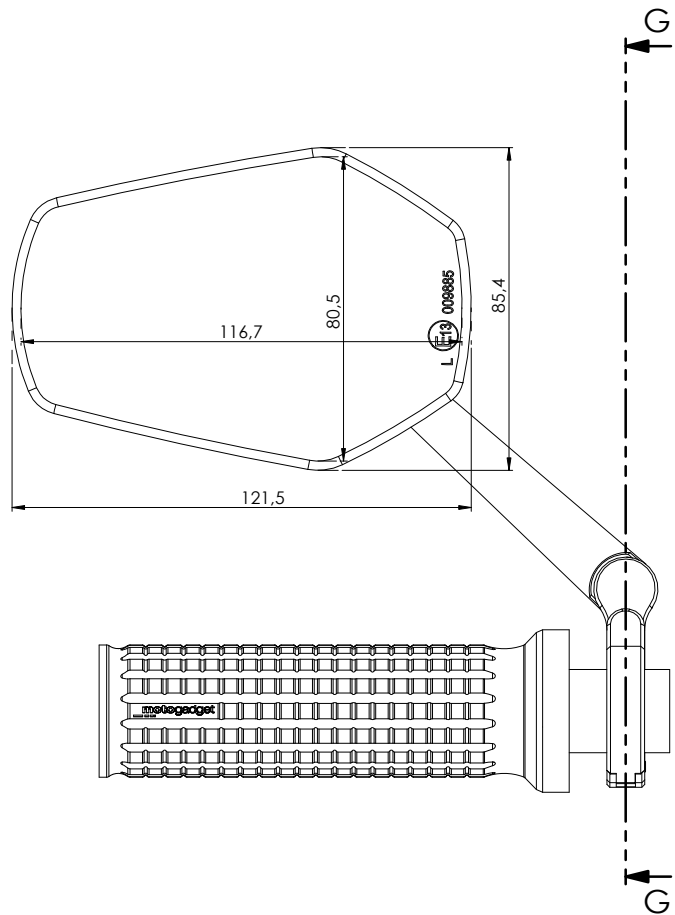

SCHNITT G-G
MAßSTAB 1 : 1

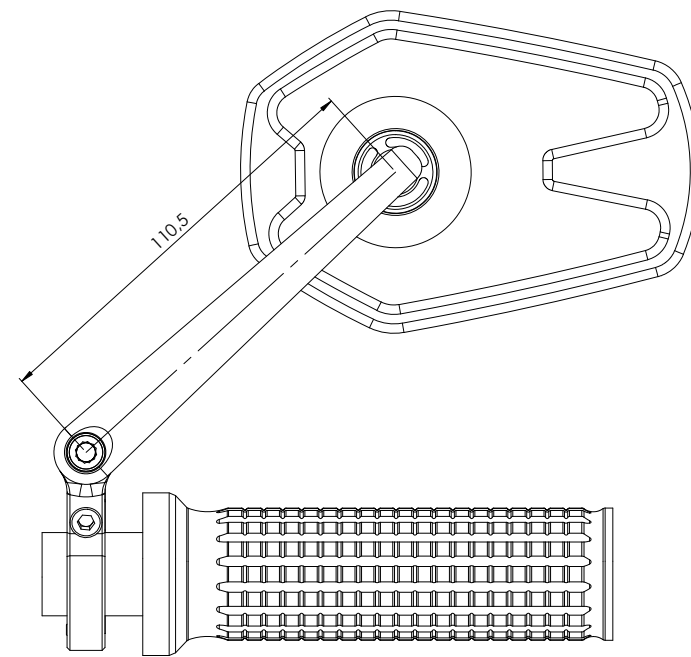

E13*81R00/02*9885*02
Société Nationale de Certification et d'Homologation

motogadget GmbH proprietary & confidential

Spiegelkörper: DRIFT
Arm: 110mm
Gelenk: pivot
SKU: 7006061 (22mm)
7006062 (25mm)

Spiegelarm ist schwenkbar in diskreten 45° Rastschritten

WENN NICHT ANDERS DEFINIERT: BEWÄSSUNGEN SIND IN MILLIMETER		OBERFLÄCHENGÜTE:		ENTGRATEN UND SCHARFE KANTEN RUFEN		ZEICHNUNG NICHT SKALIEREN		ÄNDERUNG	
OBERFLÄCHENBESCHAFFENHEIT: FOLGENZEN: LINEAR: WINKEL:									
BEZEICHNUNG	NAME	SIGNATUR	DATUM			BEZUGSRING:			
ZEICHNER						mo.view_drift			
ZEICHENMÜSSE									
PRODUKTION				WERKSTOFF:		ZEICHNUNGSNR.			
QUALITÄT									
				GEWICHT:		MAßSTAB: 1			
						BLATT 2 VON 10			
						A2			

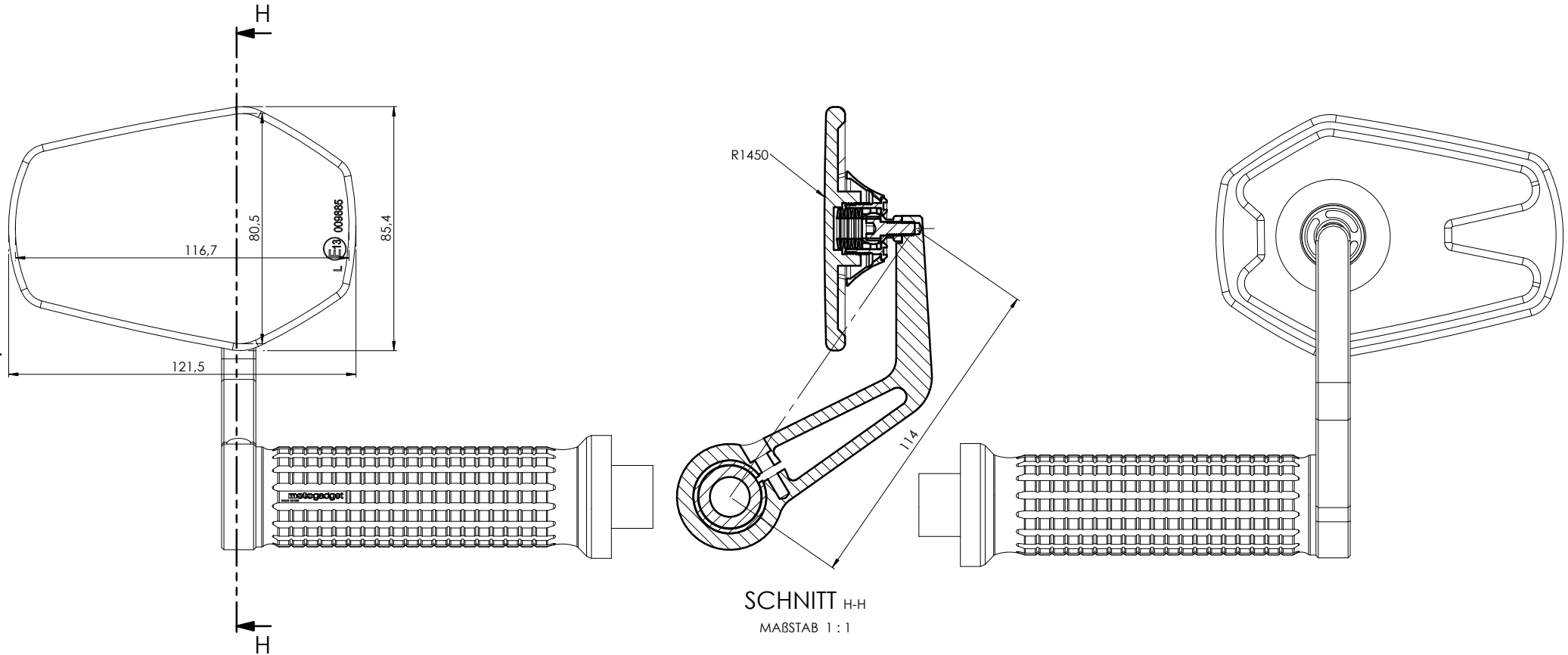

SCHNITT H-H
MAßSTAB 1 : 1

Spiegelkörper: DRIFT
Arm: 130mm
Gelenk: fix
SKU: 7006052

motogadget GmbH proprietary & confidential

WENN NICHT ANDERS DEFINIERT: BEWÄSSUNGEN SIND IN MILLIMETER		OBERFLÄCHENGÜTE:		ENTGRATEN UND SCHARFE KANTEN RÄUHEN		ZEICHNUNG NICHT SKALIEREN		ÄNDERUNG	
OBERFLÄCHENBESCHAFFENHEIT: TOLERANZEN: LINEAR: WINKEL:									
BEZEICHNET:	NAME	SIGNATUR	DATUM			REFERENZ:			
SIEHPUNKT:						mo.view_drift			
SIEHEWEGE:									
PRODUKTION:						WERKSTOFF:		ZEICHNUNGSNR.	
QUALITÄT:								A2	
				GEWICHT:		MAßSTAB: 1		BLATT 8 VON 10	

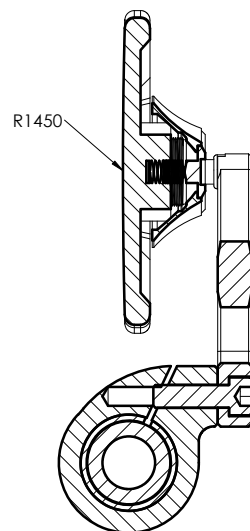
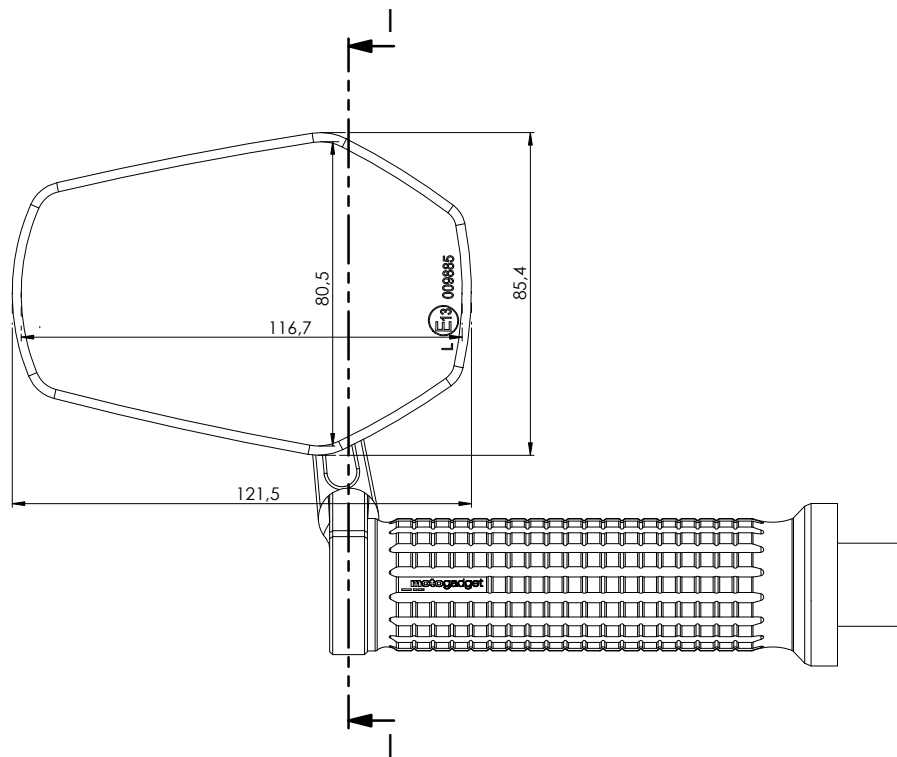

SCHNITT H
MAßSTAB 1 : 1

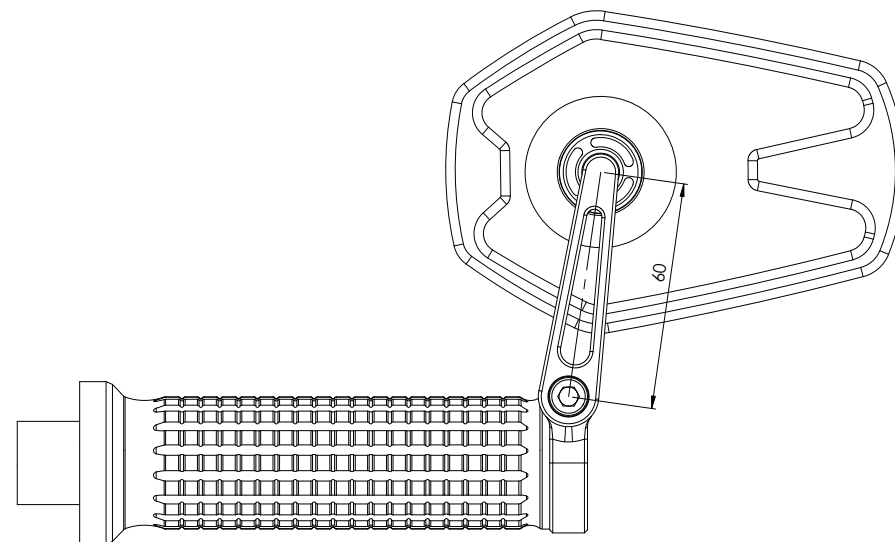

Spiegelkörper: DRIFT
Arm: 60mm
Gelenk: fix
SKU: 7006050

motogadget GmbH proprietary & confidential

WENN NICHT ANDERS DEFINIERT: BEWASSUNGEN SIND IN MILLIMETER		OBERFLÄCHENGÜTE:		EINGRATEN UND SCHARFE KANTEN BRUCHEN		ZEICHNUNG NICHT SKALIEREN		ÄNDERUNG	
OBERFLÄCHENBESCHAFFENHEIT: TOLERANZEN: LINEAR: WINKEL:									
BEZEICHNET:		NAME		SIGNATUR		DATUM		REFERENZ:	
ZEICHNET:								mo.view_drift	
GEZEICHNET:									
PRODUKTION:									
QUALITÄT:									
				WERKSTOFF:		ZEICHNUNGSNR.		A2	
				GEWICHT:		MAßSTAB: 1		BLATT 2 VON 10	

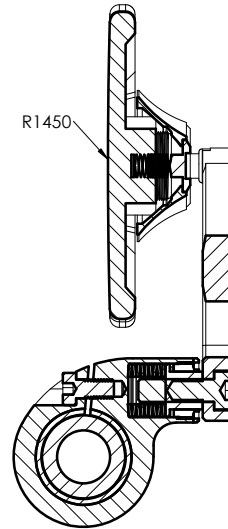
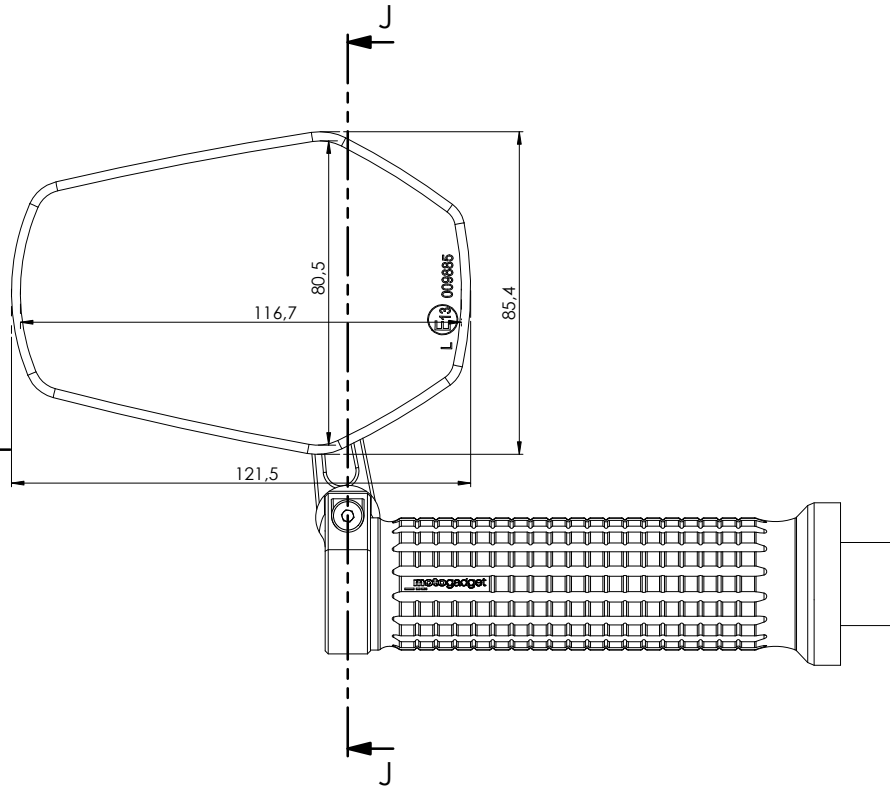

SCHNITT J-J
MABSTAB 1 : 1

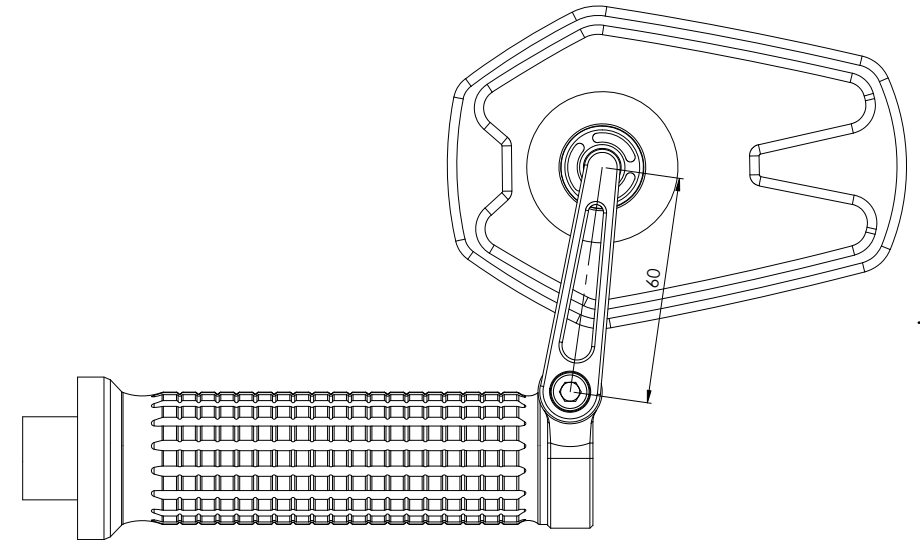

Spiegelkörper: DRIFT
Arm: 60mm
Gelenk: flip
SKU: 7006051

Spiegelarm ist schwenkbar in diskreten 45° Rastschritten

motogadget GmbH proprietary & confidential

WENN NICHT ANDERS DEFINIERT: BEWASSUNGEN SIND IN MILLIMETER		OBERFLÄCHENGÜTE:		ENTCRATEN UND SCHARFE KANTEN BRUCHEN		ZEICHNUNG NICHT SKALIEREN		ÄNDERUNG	
OBERFLÄCHENBESCHAFFENHEIT: FOKUSANZEIGEN: LINEAR: WINKEL:									
BEZEICHNET:	NAME	SIGNATUR	DATUM			REFERENZ:			
SIEHPFAD:						mo.view_drift			
SIEHPUNKT:									
PRODUKTION:									
QUALITÄT:				WERKSTOFF:		ZEICHNUNGSNR.			
						A2			
				GEWICHT:		MASSSTAB: 1			
						BLATT 10 VON 10			